



GRIP Head office (Jinsung Eurotec co., ltd.)

#817 Daerung technotown 12nd Gasandigital 2 ro 14 Geumcheon-gu Seoul Republic of korea.

GRIP Factory

#b101-201 397 Seckcheon-ro Buchun-si Gyeonggi-do Republic of Korea

Tel.+82 32 624 0907~8

Fax.+82 32 624 0909

gripperfect@gmail.com

www.gripkorea.com



HYDRO-VS

Compact, very short type. For machine room space.

New!!

New design



HYDRO-VS

**Hydro-vs can secure maximum machine space.
Minimize interference. Long tools are available.**

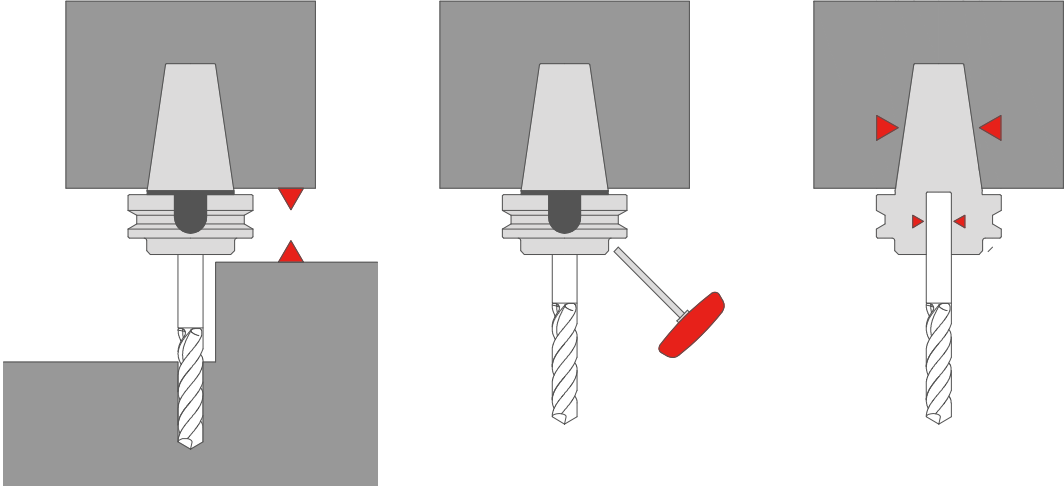

**Precision and Run-out
Guaranteed.**

Standard run-out 3xd 3 μm .

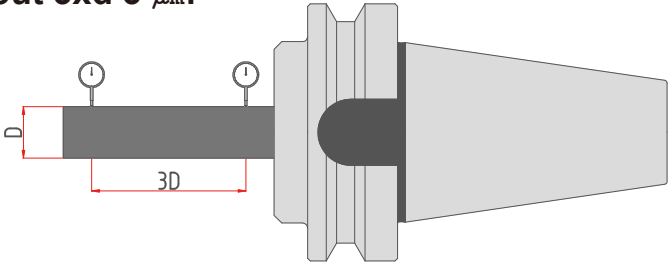

**Can be ideally combined with
hydro-zero extension.**



VS

Dimensions(mm)

BT40		D1	D2	D3	D4	L1	L2	L3	L4	Clamping wrench	Adjustment bolt (wrench)	Kg.
BT40/GVS20/40	●	20	50	-	-	40	51.5	41.5	13	TR-4.0	-	1.1

BT50		D1	D2	D3	D4	L1	L2	L3	L4	Clamping wrench	Adjustment bolt (wrench)	Kg.
BT50/GVS32/51	●	32	70.5	-	-	51	65	55	13	TR-5.0	-	3.8

SK40		D1	D2	D3	D4	L1	L2	L3	L4	Clamping wrench	Adjustment bolt (wrench)	Kg.
SK40/GVS20/32	●	20	50	-	-	32	47.5	37.5	12.9	TR-4.0	-	0.9

SK50		D1	D2	D3	D4	L1	L2	L3	L4	Clamping wrench	Adjustment bolt (wrench)	Kg.
SK50/GVS32/32	●	32	70.5	-	-	32	65	55	12.9	TR-5.0	-	2.9

Availability: ● Stock ▲ Short lead time ○ Made to order

- »h6 shank tools must be used.
- »Tool length can be adjusted up to 10mm.
- »T-wrench is must be ordered separately. (GRIP torque wrench is recommended.)
- »All products center through coolant system.
- »Additional sizes and special designs available on request.

⚠ The minimum tool depth must be observed.

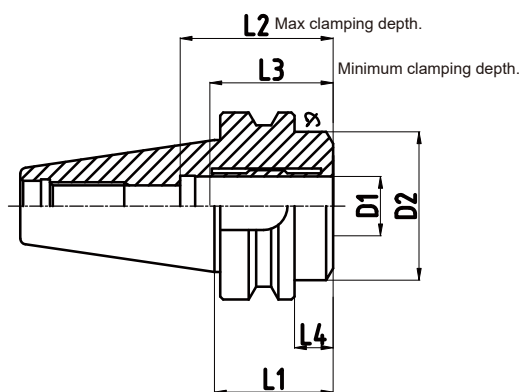

BT40/BT50

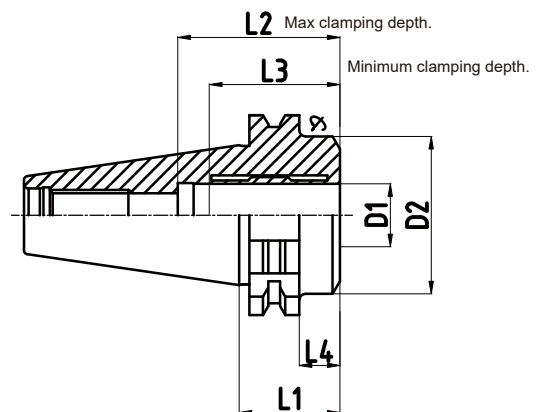

SK40/SK50